

# STAR GUARD

## SAFE GUARD WITH STAR GUARD

Toll Free Office: 1-866-650-7827

Toll Free Fax: 1-866-778-4411

\*US & International Patents Pending

8' Cut-to-fit Stainless Steel Floor Mounted Railing Install Guide  
(5' 5" male + 3' female)

### STAR GUARD SAFEGUARD WITH STARGUARD

Installation Sheet for Stainless Steel Mounted Railing: Sliding/Adjustable Legs & Cut-To-Fit

#### Tools Needed for this installation:

- Tape Measure
- Pencil
- Rubber Mallet
- Chalk Line
- 1" Mortar Drill Bit
- Hammer Drill
- Hot Saw
- Allen Key



US & International Patents Pending

#### STEP 1: Layout

Lay rail sections in front of the case to be protected (they should be 1/2" off the case). Use a chalk line to ensure a straight line for guidance when drilling the holes.

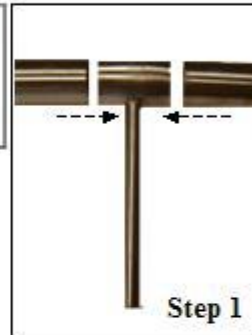

#### STEP 2: Drilling Holes

1. Slide leg/cuff onto the railing.
2. The legs on the ends should be 12" from the rail end caps. The middle of the rail is where the next leg will be placed and the leg of the 2<sup>nd</sup> rail will butt-up against the first one and a cuff/leg will close off any gap. (See photo insert)
3. Trace a circle on the floor around each leg.
4. Using a 1" drill bit, drill a 3" deep hole
5. Vacuum dust from the drilled holes.

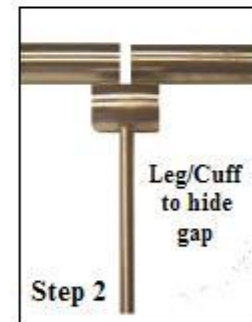

#### STEP 3: Installing Metal Flange Kit & Stainless Steel Railing

1. 1<sup>st</sup> insert rubber anchor into hole
2. Next place the metal flange in the hole & strike with rubber mallet until metal flange is flush to the floor.
3. The flange + insert should be flush with the floor surface.
4. Insert railing into holes with NO GAPS in between the rails. Please butt the rails up against each other (*step 2 photo*) and slide the cuff/leg over the area where the 2 rails meet and secure the cuff by tightening the 2 set screws on the back side of cuff (*step 3 photo*).
5. Use the allen wrench to tighten the set screws.
6. Apply lock tight to screws once tightened. (Set screw must face the case)

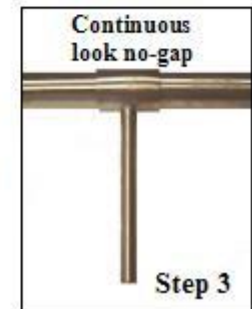

Installation Sheet for Stainless Steel Mounted Railing: Sliding/Adjustable Legs & Cut-To-Fit

Important: Make sure there are NO SHARP edges!

Important: CUT THE OPEN END ONLY!

**STEP 4: Cut-To-Fit Railing**

1. There are 2 pieces of this rail that measure out to be either 4' in total length or 8' in total length.
2. The male end has a 6" extension.
3. The female end has no extension and 1 opened end.
4. Place the railing with legs attached along the case (1/2" distance off the case). Mark the female end of railing that needs to be cut off.
5. Use hot saw to cut female end, then place this end onto the male end and insert into the floor. (SLIDE EXTRA "CUFF" WITH NO LEG ATTACHED OVER THE NEWLY CUT AREA)
6. Ex: if you need 7' to cover the last side of the case, then you would cut 1' off the female end of the railing. The female end slips onto the male end and covers the 6" extension giving you a 7' overall length.

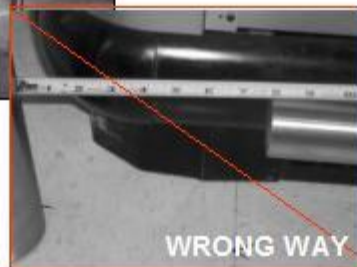
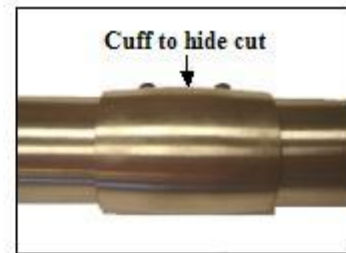
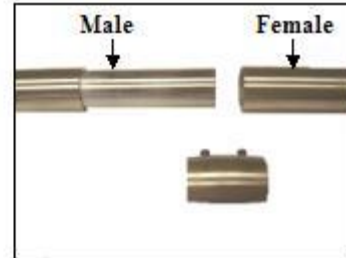
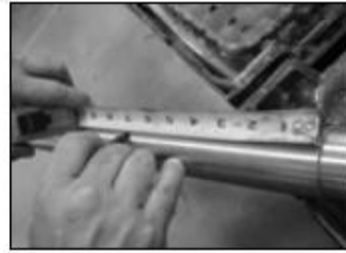

Star-Guard, LLC  
3008 N. 193<sup>rd</sup> E. Avenue  
Catoosa, OK 74015  
Phone: 918-266-7827

US & International Patents Pending

1-866-650-7827  
Fax: 918-266-2234  
1-866-778-4411